

VoIP ADAPTER KIT

DoorKing Part Number
1815-578

DoorKing's **VoIP Adapter** provides Telephone Line **VOICE** connection for DoorKing Telephone Entry Systems. This service is provided by DoorKing VoIP service, which is a subscription service. Local and long distance is included with this service including all taxes and fees. In addition, programming services via the **DoorKing 1830-186 client mode adapter** for database programming may also be selected.

Installation

The VoIP adapter may be installed near the router **OR** the entry system. 115VAC power is required to power the transformer 5VDC power supply.

When the VoIP adapter is installed near the router, the phone line out of the adapter may be run up to 1000ft to the entry system.

When the VoIP adapter is installed near the entry system, the ethernet wire run must be less than 330ft. to the router.

For longer wire runs in areas prone to lightning, either a phone or Ethernet surge suppressor is recommended.

Network Connection

The VoIP adapter **MUST** be plugged into a router port which supports **DHCP automatic IP address negotiation** (all modern routers support this feature).

Connect the VoIP adapter as close as possible to the phone entry system or router. **DO NOT** place the adapter behind secondary routers. This will prevent the adapter from connecting properly to the VoIP server. This is **especially bad** for receiving incoming telephone calls to the phone entry system.

Registration

The VoIP adapter **WILL NOT** function until registered with the **DoorKing VoIP server**.

The registration page may be reached at:

<https://dksdb.dksoftware.com/UserLogin.aspx>

Before starting the registration process, be sure to have the **VoIP ID number** written down. This number is printed on a label on the VoIP adapter box. Also the **Master Code** of the phone entry system will be needed for the registration process.

Click the **IM/VOIP DKS** button on the first screen. Enter your personal information, then click the **entry systems** tab.

Add an entry system by selecting whether the service desired is **DKS VOIP/Data** or **DKS VOIP only**.

(**VOIP/Data** is voice using the VoIP adapter for entry system phone line **AND** data using the **DoorKing 1830-186 client mode adapter** for database programming. **DKS VOIP only** is voice using the **VoIP adapter** for the phone line with programming done by some other means.)

Enter the **VOIP ID number** recorded from the VoIP adapter box, the optional name of the entry system if desired, and the **postal area code** of the entry system location which will be used for entry system phone number selection. Finally, enter the **Master Code** of the entry system, then Click **ADD**.

The entry system will be added to the table above. Click the **billing** tab and enter billing information. When completed, the VoIP adapter will be turned on and a phone number will be automatically assigned to the VoIP adapter. **Make sure to record the phone number assigned to the VoIP adapter for your records.**

Testing

Plug a standard telephone into the VoIP adapter and dial tone should be heard. Make a phone call and verify good voice quality. Place a phone call to the telephone at the assigned phone number from the registration process. The phone should ring and a conversation is possible. Wire the VoIP RJ11 telephone connection to the entry system phone terminals. Wiring should be twisted pair. Do not allow the phone line to come in contact with earth ground. Follow all wiring instructions contained in the applicable telephone entry system installation manual. Test the telephone entry system using the entry system installation manual. Be sure to do a careful feedback adjustment for maximum sound quality and DTMF tone detection. For **1830 series boards** the feedback jumper **MUST be set on the 1816 pins for optimum voice quality** (distortion occurs if jumper is not set on 1816 pins).

Place a phone call from the entry system to a resident. Verify good voice quality with no hum, buzz or feedback issues. Have the resident press "**Tone 9**" on their phone to open the door or gate. Call the entry system and make sure the entry system answers the call. Testing complete.

1815-566-A-3-22

Copyright 2022 DoorKing®, Inc. All rights reserved.

VoIP Box Installed at Router

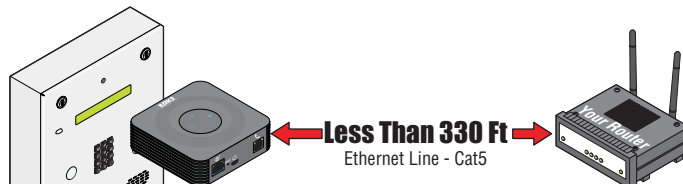
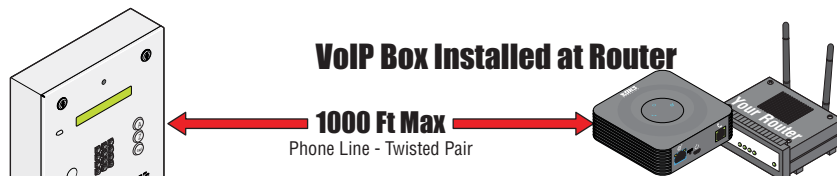

VoIP Box Installed at Phone Entry System

DO NOT use this VoIP device to make 911 calls.

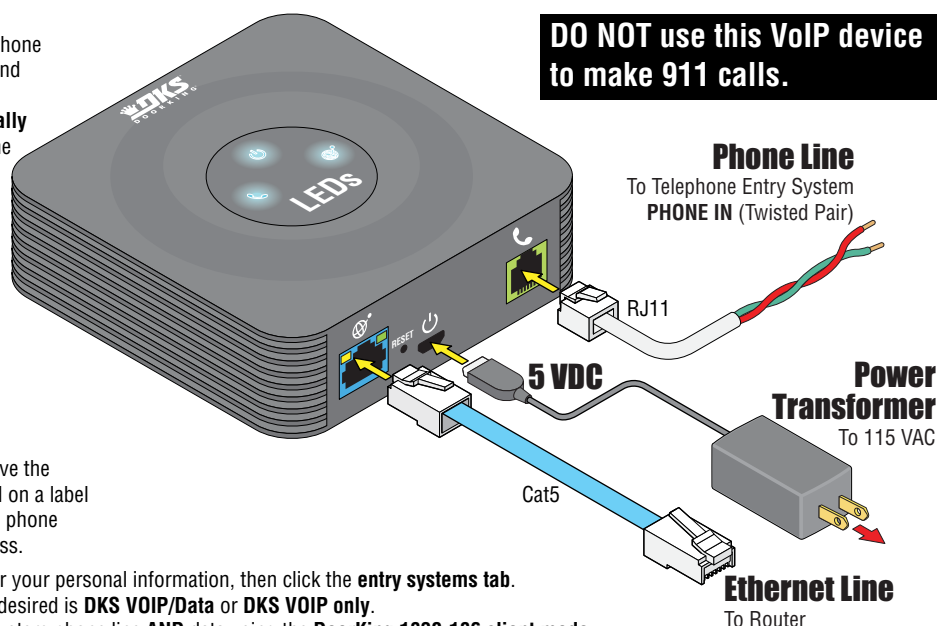

DKS
DOORKING
120 S. Glasgow Avenue
Inglewood, California 90301 U.S.A.