

EAGLE 1000-2000-2000APT PARTS LIST AND ILLUSTRATIONS

OPERATOR PARTS

EAGLE-1000, EAGLE-2000 & EAGLE-2000-APT SERIES

Note: Illustrations may not be to scale and are designed as representative parts and components. Some parts are shared by each gate operator model. See page at right for the Item Number, Part Number, and Description for your specific gate operator model.

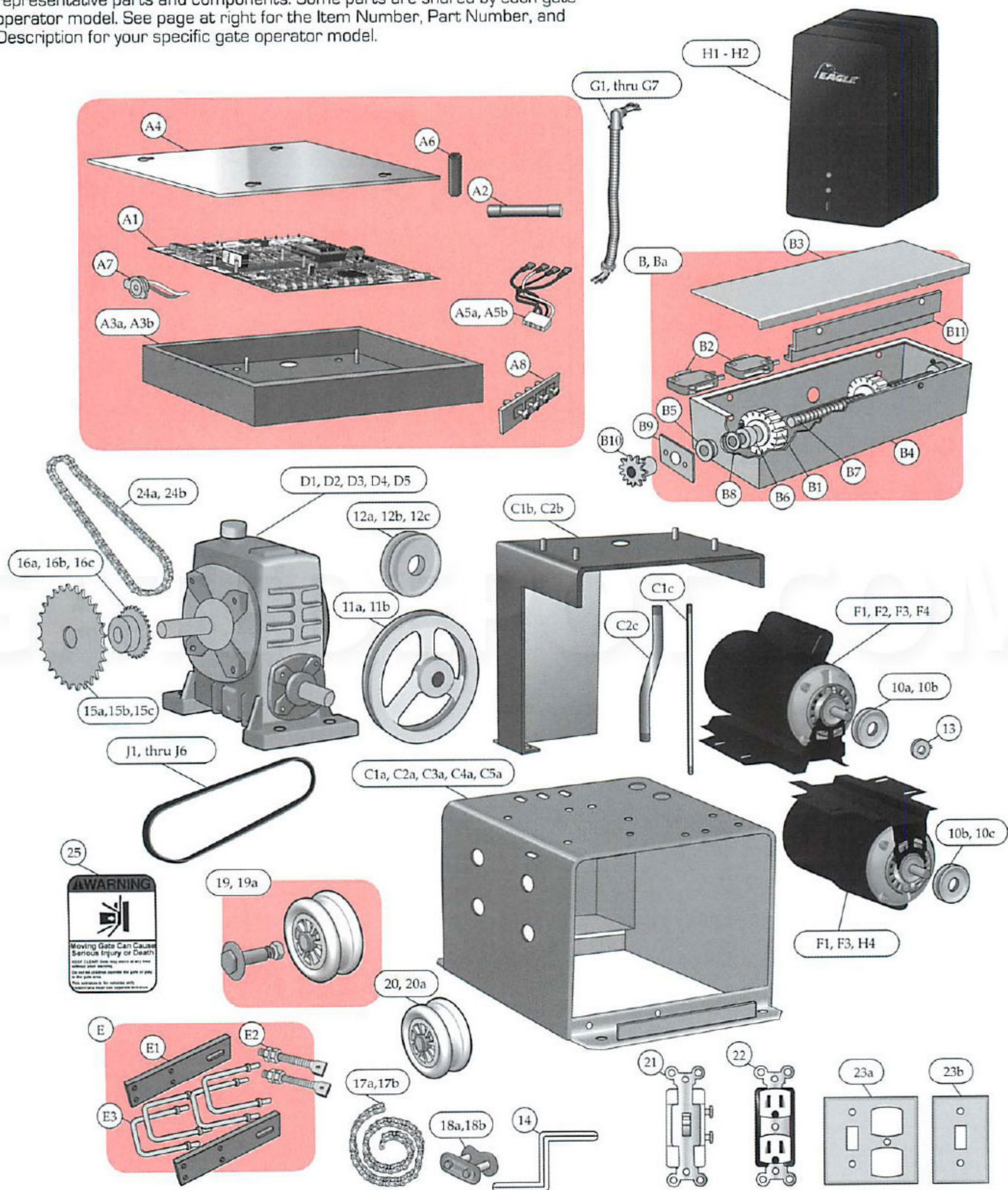

EAGLE 1000-2000-2000APT PARTS LIST AND ILLUSTRATIONS

OPERATOR PARTS

EAGLE-1000, EAGLE-2000 & EAGLE-2000-APT SERIES

ITEM	PART NO.	DESCRIPTION (INCLUDING MODEL OR OPERATOR)
A1	E555	Eagle Diamond Control Board
A2	E556	15 Amp Slow Blow Fuse (Diamond Control Board)
A3a	E553	Control Board Box (Eagle-2000 Series & Eagle-2000-APT Series)
A3b	E292	Control Board Box (Eagle-1000 Series)
A4	E293	Cover - Control Board Box
A5a	E032	Receiver Harness (Eagle-2000 & Eagle-2000-APT Series)
A5b	E022	Receiver Harness (Eagle-1000 Series)
A6	E561	Eagle Diamond Control Board Stand - off
A7	E562	Eagle Siren
A8	E563	Receiver Terminal Strip

ITEM	PART NO.	DESCRIPTION (INCLUDING MODEL OR OPERATOR)
B	E106	Limit Switch Assembly (Eagle-2000 & Eagle-2000-APT Series)
Ba	E094	Limit Switch Assembly (Eagle-1000 Series)
B1	E108	Limit Adjustment Cam - Limit Switch Assembly
B2	E097	Limit Switch - Limit Switch Assembly
B3	E107	Cover Plate - Limit Switch Assembly
B4	E110	Limit Box - Limit Switch Assembly
B5	E098	Bearing - Limit Switch Assembly
B6	E100	Shaft Collar- Limit Switch Assembly
B7	E109	Threaded Shaft - Limit Switch Assembly
B8	E112	Nylon Washer - Limit Switch Assembly
B9	E113	Retaining Plate with Screws - Limit Switch Assembly
B10	E099	Sprocket - Limit Switch Assembly
B11	E119	Locking Plate - Limit Switch Assembly

ITEM	PART NO.	DESCRIPTION (INCLUDING MODEL OR OPERATOR)
C1a	E200	Lower Chassis (Eagle-2000-FSF & Eagle-2000-FSC)
C1b	E201	Upper Chassis (Eagle-2000 & Eagle-2000-APT Series)
C1c	E202	Support - Chassis (Eagle-2000 & Eagle-2000-APT Series)
C2a	E203	Lower Chassis (Eagle-2000-1HP/DM)
C2b	E198	Upper Chassis (Eagle-1000 Series)
C2c	E211	Support - Chassis (Eagle-1000 Series)
C3a	E206	Lower Chassis (Eagle-2000-APT)
C4a	E214	Lower Chassis (Eagle-2000-APT 1.5HP/DM)
C5a	E199	Lower Chassis (Eagle-1000 Series)

ITEM	PART NO.	DESCRIPTION (INCLUDING MODEL OR OPERATOR)
D1	E181	Gear Reducer (Eagle-2000-FSF, Eagle-2000-1HP/DM)
D2	E251	Gear Reducer (Eagle-2000-FSC)
D3	E252	Gear Reducer (Eagle-2000-APT Series)
D4	E281	Gear Reducer (Eagle-1000-FSF)
D5	E159	Gear Reducer (Eagle-1000-FSC)

ITEM	PART NO.	DESCRIPTION (INCLUDING MODEL OR OPERATOR)
E	E300	No-Weld Chain Kit (chain not included)
E1	E305	Chain Bracket
E2	E306	Chain Bolt with Nuts
E3	E307	U-Bolt with Nuts - Chain Kit

ITEM	PART NO.	DESCRIPTION (INCLUDING MODEL OR OPERATOR)
F1	E185	1/2 HP Motor with Keyway (Eagle-2000 Series)
F2	E209	1/2 HP Motor with Keyway (Eagle-1000 Series)
F3	E210	1 HP Motor with Keyway (Eagle-2000-APT & Eagle-2000-APT-DM)
F4	E288	3/4 HP Motor with Keyway (Eagle-2000-APT-1.5HP)

ITEM	PART NO.	DESCRIPTION (INCLUDING MODEL OR OPERATOR)
G1	E031	Motor Harness with Flex & Connectors (Eagle-2000-FSF & Eagle-2000-FSC)
G2	E404	Motor Harness with Flex & Connectors (Eagle-2000-1HP)
G3	E405	Motor Harness with Flex & Connectors (Eagle-2000-DM)
G4	E406	Motor Harness with Flex & Connectors (Eagle-2000-APT)
G5	E407	Motor Harness with Flex & Connectors (Eagle-2000-APT-1.5HP)
G6	E408	Motor Harness with Flex & Connectors (Eagle-2000-APT-DM)
G7	E400	Motor Harness with Flex & Connectors (Eagle-1000 Series)

ITEM	PART NO.	DESCRIPTION (INCLUDING MODEL OR OPERATOR)
H1	E333	Cover - Gate Operator (Eagle-2000 & Eagle-2000-APT Series)
H2	E351	Cover - Gate Operator (Eagle-1000 Series)

ITEM	PART NO.	DESCRIPTION (INCLUDING MODEL OR OPERATOR)
J1	E283	V-Belt - Eagle-2000-FSF
J2	E282	V-Belt - Eagle-2000-FSC & Eagle-2000-APT
J3	E284	V-Belt - Eagle-2000-1HP/DM
J4	E603	V-Belt - Eagle-1000-FSF
J5	E604	V-Belt - Eagle-2000-APT-1.5HP/DM
J6	E285	V-Belt - Eagle-1000-FSC

ITEM	PART NO.	DESCRIPTION (INCLUDING MODEL OR OPERATOR)
10a	E266	Pulley - Motor (Eagle-1000-FSF & Eagle-2000-FSF)
10b	E255	Pulley - Motor (Eagle-1000-FSC & Eagle-2000-FSC/1HP/DM & Eagle-2000-APT Series)
10c	E275	Pulley - Lower Motor (Eagle-2000-1HP/DM)
11a	E144	Pulley - Gear Reducer (Eagle-2000-FSF/1HP/DM)
11b	E145	Pulley - Gear Reducer (Eagle-1000 FSF)
12a	E277	Pulley - Gear Reducer (Eagle-2000-FSC)
12b	E278	Pulley - Gear Reducer (Eagle-1000-FSC)
12c	E276	Pulley - Gear Reducer (Eagle-2000-APT Series)
13	E286	Crank Input
14	E257	Crank
15a	E166	Sprocket for Gate Chain - Gear Reducer (Eagle-2000 Series)
15b	E265	Sprocket for Gate Chain - Gear Reducer (Eagle-1000 Series)
15c	E371	Sprocket for Gate Chain - Gear Reducer (Eagle-2000-APT Series)
16a	E167	Limit Chain Sprocket - Gear Reducer (Eagle-2000 Series)
16b	E267	Limit Chain Sprocket - Gear Reducer
16c	E268	Limit Chain Sprocket - Gear Reducer (Eagle-2000-APT Series)
17a	XM208	10 ft., #40 Nickel-plated Roller Chain (Eagle-2000 & Eagle-2000-APT Series)
17b	XM200	10 ft., #41 Nickel-plated Roller Chain (Eagle-1000 Series)
18a	XM248	#40 Master Link
18b	XM244	#41 Master Link
19	E168	Idler Pulley Assembly Complete - Gate Chain (Eagle-2000 & Eagle-1000 Series)
19a	E651	Idler Pulley Assembly Complete - Gate Chain (Eagle-2000-APT Series)
20	E652	Idler Pulley - Gate Chain (Eagle-2000 & Eagle-1000 Series)
20a	E653	Idler Pulley - Gate Chain (Eagle-2000-APT Series)
21	E132	Main Power Cut-off Switch
22	E136	Electrical Outlet (Eagle-2000 & Eagle-2000-APT Series)
23a	E135	Switch Plate (Eagle-2000 & Eagle-2000-APT Series)
23b	E133	Switch Plate (Eagle-1000 Series)
24a	E242	Limit Chain (Eagle-2000 & Eagle-2000-APT Series)
24b	E241	Limit Chain (Eagle-1000 Series)
25	E997	Warning Sign