

LOCKEY M-210 DEADBOLT INSTALLATION INSTRUCTIONS

M210 | M210 EZ | M210 DC | M210 EZ DC

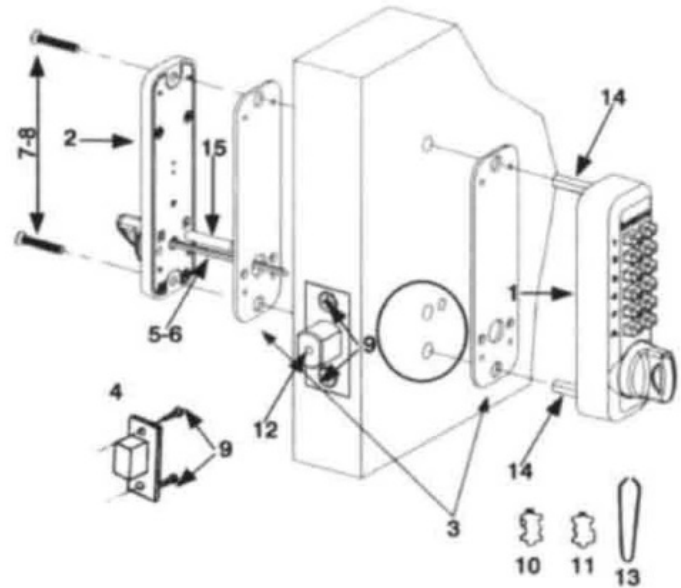

No.	Part Name	M210	M210 EZ
1	Outside Body	1	1
2	Inside Body	1	1
3	Rubber Trim Plate	2	0
4	Mortised Strike	1	1
5	Spindle 40-55 mm.	1	1
6	Spindle 30-45mm.	1	1
7	Machine Screw M4 x 50 mm.	2	2
8	Machine Screw M4 x 35 mm.	2	2
9	Wood Screw M4	4	4
10	Extra Code Tumblers (Red)	1	1
11	Extra Non-Code Tumblers (Blue)	2	2
12	Adjustable Deadbolt 2 3/8" – 2 3/4"	1	1
13	Tweezers	1	1
14	Hex Bolts	2	0
15	Brass Support Pin	1	1
16	EZ-Plates-M210 EZ (Not Shown)	0	1



Step 1: Change User Code (OPTIONAL)

If you wish to change your code, see instructions on reverse side.

FOR M210 EZ Instructions, turn to reverse side.

Step 2: Prep Door for Installation with Template

1. Place template (supplied) on door and fold along door's edge.
2. Mark holes for 2 3/8" or 2 3/4" backset.
3. Drill holes as instructed.

NOTE: For Pre-Prepped 2 1/8" doors, you only need to drill top hole.

Step 3: Identify Door Handing

Right-Hand Doors – From exterior of door, hinges are on right-side. (Fig. 1)

Left-Hand Doors – From exterior of door, hinges are on left-side. (Fig. 2)

The M210 is factory pre-handed for right-hand doors. To change handing, remove two blue screws and cover plate from Outside Body.

Now, move the pin from the right side of the outside body to the hole on the left side. Replace plate and screws.

***M210 DC – Inside Body handing pin must be placed on opposite side from Outside Body.**

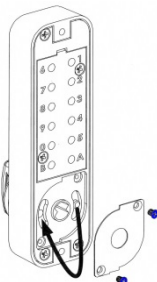
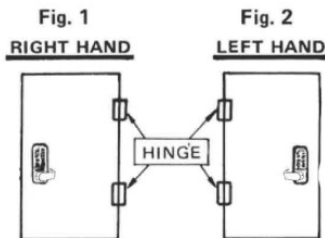

Step 4: Install Support Pin & Hex Bolts

Install Brass Support Pin (#15) into either hole on Inside Body as shown in the figure to the Right [Left].

Install/screw Hex Bolts (#14) into the top and bottom of the Outside Body as shown in the figure (Far Right).

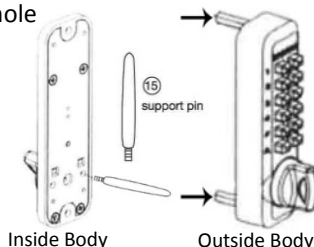

Step 5: Adjust Deadbolt (if necessary) & Install

1. Adjustable Deadbolt (#12) is preset to 2 3/8". To adjust, lift pin and slide to 2 3/4".
2. With arrow pointed UP, insert Deadbolt and secure with two (2) Wood Screws (#11).

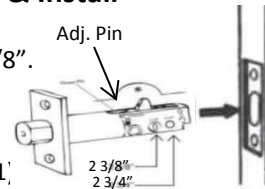

Step 6: Verify Correct Spindle Length

1. With deadbolt (#12) installed, hold the Inside Body (#2) and Rubber Trim Plate (#3) to the door.
2. Place Spindle (#5/6) through Deadbolt, into the Inside Body, as far as possible.
3. Spindle should extend from exterior of door 3/8" min. – 5/8" max.
4. If the 30-45 mm (#6) is too long, cut it to the correct length.

IMPORTANT: If spindle extends less than 3/8" it may not engage the lock. If spindle extends more than 5/8", it will cause the lock to bind.

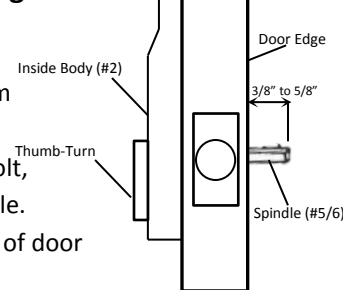

Step 7: Install the Lockey M210

5. Place the Rubber Trim Plate (#3) on the backside of the Outside Body (#1).
6. Place the Outside Body on the door. The hexagonal bolts (#14) should extend into the top and bottom holes.
7. The Support Pin (#15) on the Inside Body should fit into and extend through the hole in the Deadbolt (#12).

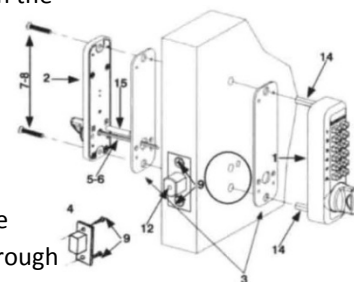

INSTRUCTIONS CONTINUED ON REVERSE SIDE

Step 7 cont: Install the Locky M210

1. Insert the Spindle (#5/6) into the Outside Body (#1) ensuring it's in the proper angled position.
**(SEE FIGURES BELOW)*
2. Using a screwdriver, secure the lock to the door with the Screws (#7 or #8).
Screw length dependent on door thickness.
3. Test the operation of the Deadbolt by turning the inside thumbturn.
4. Locate position where Deadbolt strikes door frame And install Mortised Strike (#4).

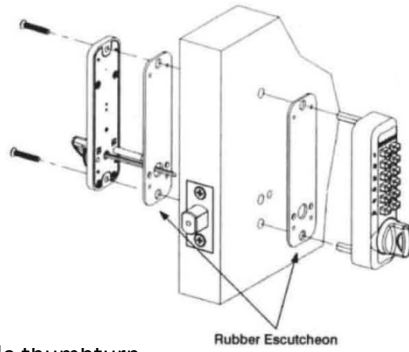

*IMPORTANT: SPINDLE POSITION/ANGLE

RIGHT-HAND DOORS: From inside, place spindle through Deadbolt, into the Outside Body (#1) in the 2:00/8:00 position as shown to right.

LEFT-HAND DOORS: From inside, place spindle through Deadbolt, into the Outside Body (#1) in the 10:00/4:00 position as shown to right.

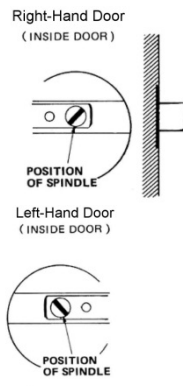

M210 EZ Installation Instructions

The M210 EZ is designed for doors with standard 2 1/8" prep

1. Determine door handing. Refer to Step #3 on reverse side.
2. Place the Outside Body #1 on EZ-Plate A (shown below) and screw into place with two (2) M5 x 1/2" screws.
3. Place the Brass Support Pin (#15) into Plate B on either side.
4. Install Adjustable Deadbolt into door. Refer to Step #4 on reverse side.
5. Place Plate A with Outside Body attached to outside of door. Place Plate B to the inside of door making sure Support Pin fits through hole in the Deadbolt. Hold tight to door and secure using two (2) M4 x 35 mm. or M4 x 50 mm. screws.
6. Place the Spindle (#7 or #8) into the large hole in Plate B, through the Deadbolt and into the Outside Body. Refer to Step 6 on reverse side and Step 7 (to left) to verify correct spindle length and position.
7. Place Inside Body to Plate B and secure using two (2) screws.
8. Test the operation of the Deadbolt by turning the inside thumbturn.

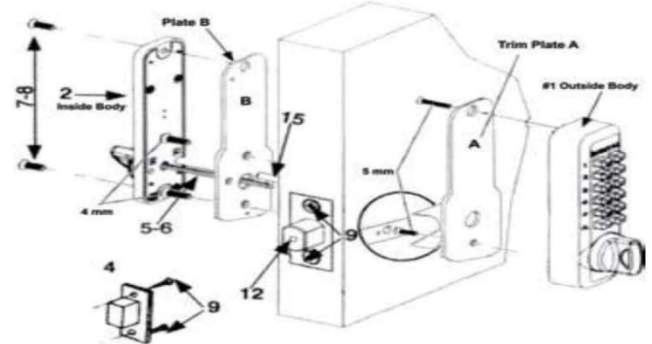

LOCKEY M-SERIES HOW TO CHANGE CODE



1. Using a #2 screwdriver, remove the two (2) Red Screws.
2. Carefully remove cover plate.
WARNING: Springs are attached to plate.

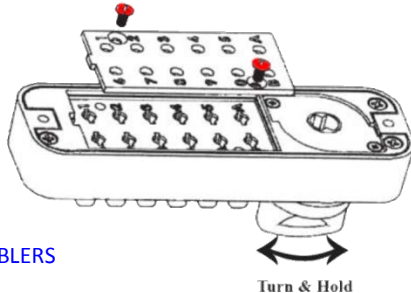

RED = CODE TUMBLERS
BLUE = NON-CODE TUMBLERS

Turn & Hold

3. **TURN & HOLD** thumb-turn to right or left to release tumblers.
IMPORTANT: THUMB-TURN MUST be turned and held when removing and inserting tumblers. Failure to do so will damage the lock and void the warranty.

WARNING:

Do **NOT** force tumblers into position!

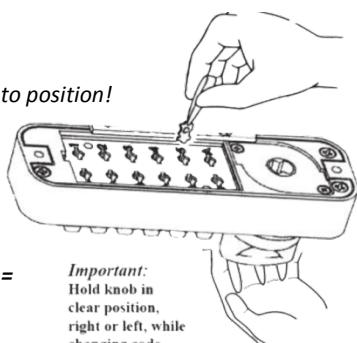

**TURNING THUMB-TURN =
CLEAR POSITION**

*Important:
Hold knob in
clear position,
right or left, while
changing code*

4. With the thumb-turn held to right or left, remove/add **CODE (Red)** and **NON-CODE (Blue)** Tumblers to create your desired code.

Ex: 3 Red = 3-Digit Code / 6 Red = 6-Digit Code

IMPORTANT: Ensure notched side of tumbler fits into slot. (Below – Far Right).

5. After changing your code, release the thumb-turn to secure the tumblers in place.

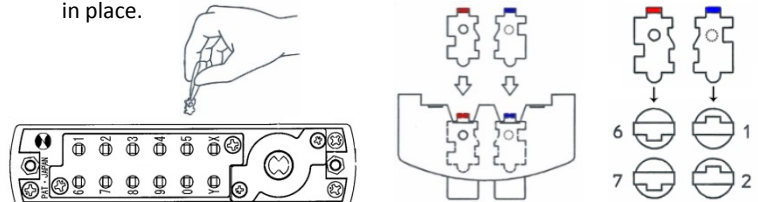

6. Replace the cover plate and secure with two (2) Red Screws, using a #2 screwdriver.
7. **TEST CODE** before installing/re-installing lock.

